



1110-TW-R Series 輕型

圓波盤系列(台灣)

Light Duty Wire & Shelving/Display (Round Raceway) (Taiwan)

- 輕型腳輪, 制成經濟, 適用於輕型置物架等。
- Light-duty, economical choice, for display racks, etc.

載重 Load
35-90 kg

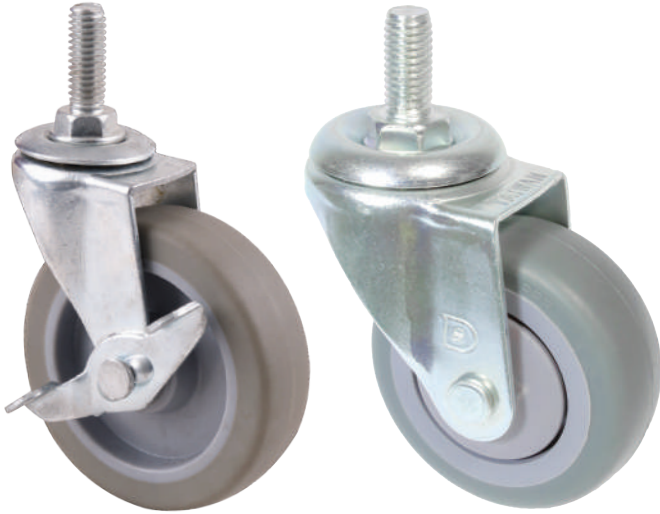

特色區 Features



軸剎
Axle Lock Brake



防撞蓋
Bumper

輪子選項 Wheel Options



高科技耐磨聚氨酯
PU on PP Core



超級人造膠
TPR on PP Core



橡膠輪
Rubber



聚乙烯輪
PVC on PP Core



全效輪
Resolute



塑料輪
PP



滑板輪
PU



滾珠軸承
Ball Bearing



中管
Plain Ball Bearing

底板規格 TOP PLATE SIZE AND BOLT HOLE SPACING

編號 Suffix	底板尺寸 Top Plate Size	底板孔距 Bolt Hole Spacing	安裝尼帽尺寸 Attaching Bolt Size
1	70 x 58 mm (2-3/4" x 2-1/4")	55.5 x 39.5 mm (2-3/16" x 1-9/16") (2" 美國輪底板)	6.35 mm (1/4")
2	96 x 69 mm (3-3/4" x 2-11/16")	75 x 52 mm / 72 x 45 mm (3" x 1-3/4") (斜孔底板)	6.35 mm (1/4")

插杆規格 CYLINDRICAL STEM SPECIFICATION

編號 Suffix	插杆直徑x長度 Diameter x Length	編號 Suffix	插杆直徑x長度 Diameter x Length
1	11X22mm (7/16" diameter X 7/8")	2	11X38mm (7/16" diameter X 1-1/2")

絲扣規格 THREADED STEM SPECIFICATION

編號 Suffix	絲扣牙徑 x 長度 Threaded Size	編號 Suffix	絲扣牙徑 x 長度 Threaded Size	編號 Suffix	絲扣牙徑 x 長度 Threaded Size
1	3/8-16UNCx25	2	3/8-16UNCx40	3	1/2-12UNCx25
4	1/2-12UNCx38	5	1/2-12UNCx40	6	1/2-13UNCx25
7	1/2-13UNCx40				



 轮径x轮宽 DiameterxWidth	 载重 Load	 材质 Material	 型号 Item No.			 轴承 Bearing	 总高 Overall Height	 回旋半径 Swivel radius	
			固定 Fixed	活动 Swivel	刹车 Brake			活动 Swivel	侧刹 Side Brake
62 mmx25 mm (2-1/2"x1")	35 kgs (77 lbs)	全效轮 Resolute	-	1110-R-25-68-2	1110-R-25-68-4	中管 Plain Bearing	87 mm (3-7/16")	活动 60mm 侧刹 64.5m	Swivel 60mm Swivel W/Side Brake 64.5mm
75mmx21mm (3"x7/8")	50 kgs (110 lbs)	高科技耐磨聚氨酯 PU on PP Core	-	1110-R-03-31-2	1110-R-03-31-4	中管 Plain Bearing	97 mm (3-13/16")	活动 66.5mm 侧刹 66.5mm	Swivel 66.5mm Swivel W/Side Brake 66.5mm
	50 kgs (110 lbs)	橡胶轮 Rubber	-	1110-R-03-06-2	1110-R-03-06-4				
75mmx24mm (3"x15/16")	60 kgs (130 lbs)	滑板轮 PU	-	1110-R-03-88-2	-	滚珠 Ball Bearing	97 mm (3-13/16")	活动 66.5mm	Swivel 66.5mm
75mmx25 mm (3"x1")	70 kgs (155 lbs)	聚乙烯輪 PVC on PP Core	-	1110-R-03-27-2	1110-R-03-27-4	中管 Plain Bearing	97 mm (3-13/16")	活动 66.5mm 侧刹 66.5mm	Swivel 66.5mm Swivel W/Side Brake 66.5mm
	60 kgs (130 lbs)	橡胶轮 Rubber	-	1110-R-03-06-2	1110-R-03-06-4				
	70 kgs (155 lbs)	超级人造胶 TPR on PP Core	-	1110-R-03-75-2	1110-R-03-75-4				
	70 kgs (155 lbs)	塑料轮 PP	-	1110-R-03-29-2	1110-R-03-29-4				
	70 kgs (155 lbs)	超级人造胶 TPR on PP Core	-	1110-R-03-75-2	-	滚珠 Ball Bearing		活动 66.5mm	Swivel 66.5mm
100mmx24mm (4"x15/16")	70 kgs (155 lbs)	滑板轮 PU	-	1110-R-04-88-2	-	滚珠 Ball Bearing	120 mm (4-11/16")	活动 81mm	Swivel 81mm
100mmx25mm (4"x1")	70 kgs (155 lbs)	高科技耐磨聚氨酯 PU on PP Core	-	1110-R-04-31-2	1110-R-04-31-4	中管 Plain Bearing	120 mm (4-11/16")	活动 81mm 侧刹 81mm	Swivel 81mm Swivel W/Side Brake 81mm
	70 kgs (155 lbs)	超级人造胶 TPR on PP Core	-	1110-R-04-75-2	1110-R-04-75-4				
	70 kgs (155 lbs)	橡胶轮 Rubber	-	1110-R-04-06-2	1110-R-04-06-4				
	90 kgs (198 lbs)	塑料轮 PP	-	1110-R-04-29-2	1110-R-04-29-4				
	70 kgs (155 lbs)	超级人造胶 TPR on PP Core	-	1110-R-04-75-2	-	滚珠 Ball Bearing		活动 81mm	Swivel 81mm
125mmx25mm (5"x1")	90 kgs (198 lbs)	高科技耐磨聚氨酯 PU on PP Core	-	1110-R-05-31-2	1110-R-05-31-4	中管 Plain Bearing	145 mm (5-3/4")	活动 94.5mm 侧刹 94.5mm	Swivel 94.5mm Swivel W/Side Brake 94.5mm
	80 kgs (176 lbs)	超级人造胶 TPR on PP Core	-	1110-R-05-75-2	1110-R-05-75-4				
	90 kgs (198 lbs)	橡胶轮 Rubber	-	1110-R-05-06-2	1110-R-05-06-4				